



22A Cedar Avenue

, Twickenham, TW2 7HE

£390,000



A MOST IMPRESSIVE AND WELL PRESENTED SEMI DETACHED FOUR/FIVE BEDROOM FAMILY HOME WITHIN MINUTES OF BOTH TWICKENHAM GREEN AND TOWN CENTRE.



FOR SALE

This fine home features the receiving hall with doors off to a lounge with bay window, 15ft study/bedroom five, splendid family/dining room with attractive wood grain flooring and bi-folding doors to garden, a cloakroom and well-appointed modern kitchen with range cooker, down lighting and door to garden. The first floor provides four, excellent size bedrooms, en-suite facilities and family bathroom. The rear garden is laid to lawn with an outbuilding suitable for a studio and off street parking to the fore. This fine home is beautifully presented with double glazing and potential to extend. An internal viewing is highly recommended.

LOCATION: The property is in the catchment area for many of the outstanding local schools and within minutes' of Twickenham Green and town centre with mainline station and the delights of Twickenham riverside.

Area Map



Floor Plans

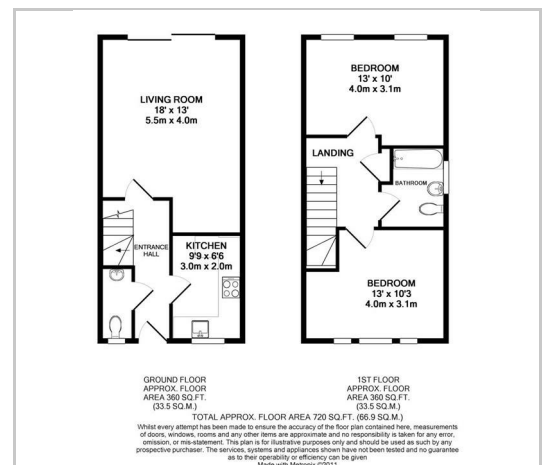

Energy Efficiency Graph

These particulars, whilst believed to be accurate are set out as a general outline only for guidance and do not constitute any part of an offer or contract. Intending purchasers should not rely on them as statements of representation of fact, but must satisfy themselves by inspection or otherwise as to their accuracy. No person in this firm's employment has the authority to make or give any representation or warranty in respect of the property.